



## **Firepower 1100 Threat Defense Getting Started: Cloud-delivered Firewall Management Center**

**First Published:** 2024-10-17

**Last Modified:** 2024-10-21

### **Americas Headquarters**

Cisco Systems, Inc.  
170 West Tasman Drive  
San Jose, CA 95134-1706  
USA  
<http://www.cisco.com>  
Tel: 408 526-4000  
800 553-NETS (6387)  
Fax: 408 527-0883





## CHAPTER 1

# Before You Begin

---

Install the firewall at a branch office and manage it on the outside interface using the Cisco Defense Orchestrator.



---

**Note** For high availability, you can use the outside interface with manual registration, but to use zero-touch provisioning, you must use the Management interface. This guide specifically covers outside management, but you can refer to [Managing Firewall Threat Defense with Cloud-Delivered Firewall Management Center in Cisco Defense Orchestrator](#) for management using the Management interface.

---

- [Power On the Firewall](#), on page 1
- [Which Application is Installed: Threat Defense or ASA?](#), on page 2
- [Access the Threat Defense CLI](#), on page 3
- [Check the Version and Reimage](#), on page 4
- [Obtain Licenses](#), on page 5
- [\(If Needed\) Power Off the Firewall](#), on page 7

## Power On the Firewall

System power is controlled by a rocker power switch located on the rear of the firewall. The rocker power switch provides a soft notification that supports graceful shutdown of the system to reduce the risk of system software and data corruption.



---

**Note** The first time you boot up the firewall, threat defense initialization can take approximately 15 to 30 minutes.

---

### Before you begin

It's important that you provide reliable power for your firewall (for example, using an uninterruptible power supply (UPS)). Loss of power without first shutting down can cause serious file system damage. There are many processes running in the background all the time, and losing power does not allow the graceful shutdown of your system.

---

**Step 1** Attach the power cord to the firewall, and connect it to an electrical outlet.

**Step 2** Turn the power on using the rocker power switch located on the rear of the chassis, adjacent to the power cord.

**Figure 1: Power Button**

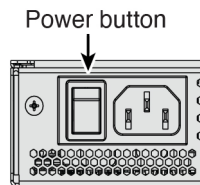

**Step 3** Check the Power LED on the back of the firewall; if it is solid green, the firewall is powered on.

**Figure 2: System and Power LEDs**

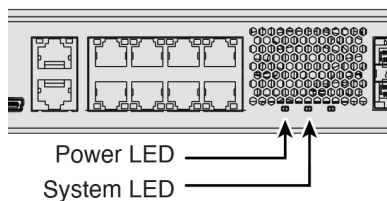

**Step 4** Check the System LED on the back of the firewall; after it is solid green, the system has passed power-on diagnostics.

## Which Application is Installed: Threat Defense or ASA?

Both applications, threat defense or ASA, are supported on the hardware. Connect to the console port and determine which application was installed at the factory.

**Step 1** Connect to the console port using either port type.

**Figure 3: Console Port**

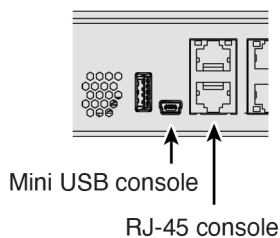

**Step 2** See the CLI prompts to determine if your firewall is running threat defense or ASA.

### Threat Defense

You see the firepower login (FXOS) prompt. You can disconnect without logging in and setting a new password. If you need to log in all the way, see [Access the Threat Defense CLI, on page 3](#).

```
firepower login:
```

**ASA**

You see the ASA prompt.

```
ciscoasa>
```

- Step 3** If you are running the wrong application, see [Cisco Secure Firewall ASA and Secure Firewall Threat Defense Reimage Guide](#).
- 

## Access the Threat Defense CLI

You might need to access the CLI for configuration or troubleshooting.

---

- Step 1** Connect to the console port using either port type.

*Figure 4: Console Port*

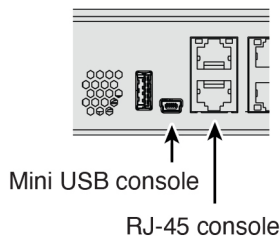

- Step 2** You connect to FXOS. Log in to the CLI using the **admin** username and the password (the default is **Admin123**). The first time you log in, you are prompted to change the password.

```
firepower login: admin
Password: Admin123
Successful login attempts for user 'admin' : 1

[...]

Hello admin. You must change your password.
Enter new password: *****
Confirm new password: *****
Your password was updated successfully.

[...]

firepower#
```

- Step 3** Change to the threat defense CLI.

**Note** If you want to use the device manager for initial setup or use zero-touch provisioning, do not access the threat defense CLI, which starts the CLI setup.

### connect ftd

The first time you connect to the threat defense CLI, you are prompted to complete initial setup.

#### Example:

```
firepower# connect ftd
>
```

To exit the threat defense CLI, enter the **exit** or **logout** command. This command returns you to the FXOS prompt.

#### Example:

```
> exit
firepower#
```

## Check the Version and Reimage

We recommend that you install your target version before you configure the firewall. Alternatively, you can perform an upgrade after you are up and running, but upgrading, which preserves your configuration, may take longer than using this procedure.

### What Version Should I Run?

Cisco recommends running a Gold Star release indicated by a gold star next to the release number on the software download page. You can also refer to the release strategy described in <https://www.cisco.com/c/en/us/products/collateral/security/firewalls/bulletin-c25-743178.html>.

**Step 1** Connect to the console port using either port type.

**Figure 5: Console Port**

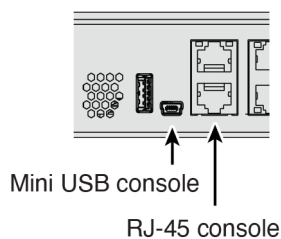

**Step 2** At the FXOS CLI, show the running version.

```
scope ssa
```

```
show app-instance
```

#### Example:

```

Firepower# scope ssa
Firepower /ssa # show app-instance

Application Name Slot ID Admin State Operational State Running Version Startup Version Cluster Oper
State
-----
-----
ftd                1      Enabled   Online           7.6.0.65      7.6.0.65      Not Applicable

```

**Step 3**

If you want to install a new version, perform these steps.

- a) By default, the Management interface uses DHCP. If you need to set a static IP address for the Management interface, enter the following commands.

**scope fabric-interconnect a**

**set out-of-band static ip ip netmask netmask gw gateway**

**commit-buffer**

**Note** If you encounter the following error, you must disable DHCP before committing the change. Follow the commands below to disable DHCP.

```

firepower /fabric-interconnect* # commit-buffer
Error: Update failed: [Management ipv4 address (IP <ip> / net mask <netmask> ) is not
in the same network of current DHCP server IP range <ip - ip>.
Either disable DHCP server first or config with a different ipv4 address.]
firepower /fabric-interconnect* # exit
firepower* # scope system
firepower /system* # scope services
firepower /system/services* # disable dhcp-server
firepower /system/services* # commit-buffer

```

- b) Perform the [reimage procedure](#) in the [FXOS troubleshooting guide](#).

You will need to download the new image from a server accessible from the Management interface.

After the firewall reboots, you connect to the FXOS CLI again.

- c) At the FXOS CLI, you are prompted to set the admin password again.

For low-touch provisioning, when you onboard the device, for the **Password Reset** area, be sure to choose **No** because you already set the password.

- d) Shut down the firewall. See [\(If Needed\) Power Off the Firewall, on page 7](#).

## Obtain Licenses

When you bought your device from Cisco or a reseller, your licenses should have been linked to your Smart Software License account. If you don't have an account on the [Smart Software Manager](#), click the link to [set up a new account](#).

If you have not already done so, register CDO with the Smart Software Manager. Registering requires you to generate a registration token in the Smart Software Manager. See the [CDO documentation](#) for detailed instructions.

The threat defense has the following licenses:

- Essentials—Required
- IPS
- Malware Defense
- URL Filtering
- Cisco Secure Client

1. If you need to add licenses yourself, go to [Cisco Commerce Workspace](#) and use the **Search All** field.

**Figure 6: License Search**

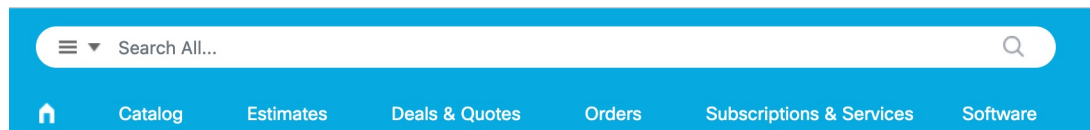

2. Search for the following license PIDs.



**Note** If a PID is not found, you can add the PID manually to your order.

- IPS, Malware Defense, and URL combination:
  - L-FPR1120T-TMC=
  - L-FPR1140T-TMC=

When you add one of the above PIDs to your order, you can then choose a term-based subscription corresponding with one of the following PIDs:

- L-FPR1120T-TMC-1Y
- L-FPR1120T-TMC-3Y
- L-FPR1120T-TMC-5Y
- L-FPR1140T-TMC-1Y
- L-FPR1140T-TMC-3Y
- L-FPR1140T-TMC-5Y
- Cisco Secure Client—See the [Cisco Secure Client Ordering Guide](#).

3. Choose **Products & Services** from the results.



Figure 7: Results

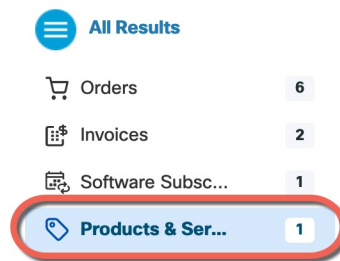

## (If Needed) Power Off the Firewall

It's important that you shut down your system properly. Simply unplugging the power or pressing the power switch can cause serious file system damage. There are many processes running in the background all the time, and unplugging or shutting off the power does not allow the graceful shutdown of your firewall system.

### Power Off the Firewall at the CLI

You can use the FXOS CLI to safely shut down the system and power off the firewall.

**Step 1** Connect to the console port using either port type.

Figure 8: Console Port

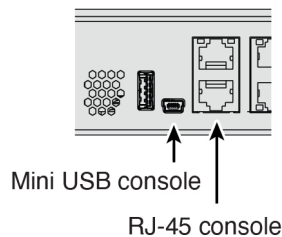

**Step 2** In the FXOS CLI, connect to local-mgmt mode.

```
firepower # connect local-mgmt
```

**Step 3** Shut down the system.

```
firepower(local-mgmt) # shutdown
```

**Example:**

```
firepower(local-mgmt)# shutdown
This command will shutdown the system. Continue?
Please enter 'YES' or 'NO': yes
INIT: Stopping Cisco Threat Defense.....ok
```

**Step 4** Monitor the system prompts as the firewall shuts down. When the shutdown is complete, you will see the following prompt.

```
System is stopped.  
It is safe to power off now.  
Do you want to reboot instead? [y/N]
```

**Step 5** You can now turn off the power switch and unplug the power to physically remove power from the chassis if necessary.

---

## Power Off the Firewall Using the Management Center

Shut down your system properly using the management center.

---

**Step 1** Shut down the firewall.

- a) Choose **Devices > Device Management**.
- b) Next to the device that you want to restart, click **Edit** (✎).
- c) Click the **Device** tab.
- d) Click **Shut Down Device** (✖) in the **System** section.
- e) When prompted, confirm that you want to shut down the device.

**Step 2** If you have a console connection to the firewall, monitor the system prompts as the firewall shuts down. When shutdown is complete, you will see the following prompt.

```
System is stopped.  
It is safe to power off now.  
  
Do you want to reboot instead? [y/N]
```

If you do not have a console connection, wait approximately 3 minutes to ensure the system has shut down.

**Step 3** You can now turn off the power switch and unplug the power to physically remove power from the chassis if necessary.

---



## CHAPTER 2

# Cable and Onboard the Firewall

Cable and onboard the firewall to CDO.

- [Cable the Firewall](#), on page 9
- [Onboard the Firewall to CDO](#), on page 10
- [Perform Initial Configuration \(Manual Provisioning\)](#), on page 15

## Cable the Firewall

- See the [hardware installation guide](#) for more information.
- Do not cable the Management interface unless you are using high availability with zero-touch provisioning. In this case, see [Managing Firewall Threat Defense with Cloud-Delivered Firewall Management Center in Cisco Defense Orchestrator](#). This guide covers only the outside interface for zero-touch provisioning.

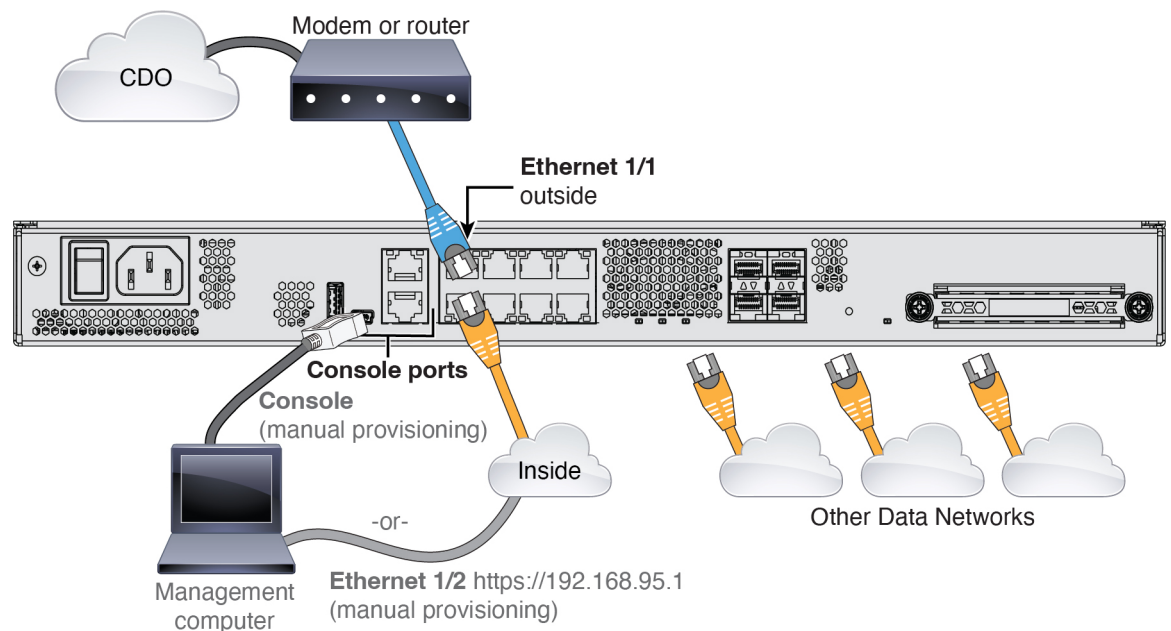

# Onboard the Firewall to CDO

Onboard the firewall using zero-touch provisioning or manual provisioning.

## Onboard the Firewall with Zero-Touch Provisioning

Onboard the threat defense using zero-touch provisioning and the device serial number.

**Step 1** In the CDO navigation pane, click **Inventory**, then click the blue plus button (  ) to **Onboard** a device.

**Step 2** Select the **FTD** tile.

**Step 3** Under **Management Mode**, be sure **FTD** is selected.

At any point after selecting **FTD** as the management mode, you can click **Manage Smart License** to enroll in or modify the existing smart licenses available for your device. See [Obtain Licenses, on page 5](#) to see which licenses are available.

**Step 4** Select **Use Serial Number** as the onboarding method.

**Figure 9: Use Serial Number**

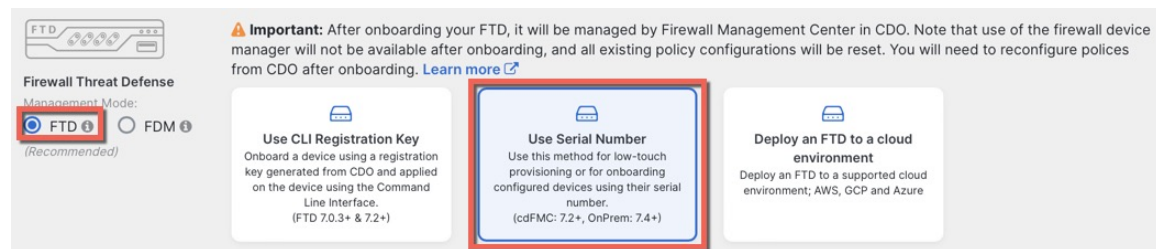

**Important:** After onboarding your FTD, it will be managed by Firewall Management Center in CDO. Note that use of the firewall device manager will not be available after onboarding, and all existing policy configurations will be reset. You will need to reconfigure policies from CDO after onboarding. [Learn more](#)

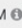
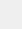
**Firewall Threat Defense**  
Management Mode:  
 **FTD**  (Recommended)  
 **FDM** 

**Use CLI Registration Key**  
Onboard a device using a registration key generated from CDO and applied on the device using the Command Line Interface. (FTD 7.0.3+ & 7.2+)

**Use Serial Number**  
Use this method for low-touch provisioning or for onboarding configured devices using their serial number. (cdFMC: 7.2+, OnPrem: 7.4+)

**Deploy an FTD to a cloud environment**  
Deploy an FTD to a supported cloud environment; AWS, GCP and Azure

**Step 5** In **Select FMC**, choose the **Cloud-Delivered FMC > Firewall Management Center** from the list, and click **Next**.

Figure 10: Select FMC

1 Select FMC Select FMC ⓘ For more details, [Click Here](#)

Select

**Cloud-Delivered FMC**

Firepower Management Center (Recommended)

**On-Prem FMCs (7.4+) ⓘ**

FMC-Securex-Onboarding-1654149835633

FMC-Securex-Onboarding-1658238180734

FMC-Securex-Onboarding-1681247022490

FMC-Securex-Onboarding-1681762232392

FMC-Securex-Onboarding-1681830086235

Boulder FMC 740-48 1543

[+ Onboard On-Prem FMC](#)

2 Connection

3 Password Reset

4 Policy Assignment

5 Subscription License

6 Done

**Step 6** In the **Connection** area, enter the **Device Serial Number** and the **Device Name** and then click **Next**.

Figure 11: Connection

2 Connection

Device Serial Number

Device Name

[Next](#)

ⓘ Enter the serial number of the FTD device you want to onboard, then CDO will attempt to connect to the device.

**Important:** Only FTD 1000, 2100 or 3100 series devices (running on software version 7.4 or later) are supported.

**Step 7** In **Password Reset**, click **Yes...** Enter a new password and confirm the new password for the device, then click **Next**. For zero-touch provisioning, the device must be brand new or has been reimaged.

**Note** If you logged into the device and reset the password, and you did not change the configuration in a way that would disable zero-touch provisioning, then you should choose the **No...** option. There are a number of configurations that disable zero-touch provisioning, so we don't recommend logging into the device unless you need to, for example, to perform a reimage.

Figure 12: Password Reset

3 Password Reset

1 Please review all the prerequisites for onboarding with a serial number. [Learn more](#)

2 Is this a new device that has never been logged into or configured for a manager?

Yes, this new device has never been logged into or configured for a manager

Enter a new password for devices that have never been configured for a manager.

**Important:** If you select this option and the device's default password has already been changed, onboarding fails.

New Password

Confirm Password

No, this device has been logged into and configured for a manager

Use this option if you already changed the password in the device CLI.

**Important:** If you select this option and the device's default password has not been changed, onboarding fails.

**Next**

**Password must:**

- Be 8-128 characters
- Have at least one lower and one upper case letter
- Have at least one digit
- Have at least one special character.
- Not contain consecutive repeated letters

**Step 8**

For the **Policy Assignment**, use the drop-down menu to choose an access control policy for the device. If you have no policies configured, choose the **Default Access Control Policy**.

Figure 13: Policy Assignment

4 Policy Assignment

Access Control Policy

Default Access Control Policy ▾

**Next**

**Step 9**

For the **Subscription License**, check each of the feature licenses you want to enable. Click **Next**.

Figure 14: Subscription License

5 Subscription License

License Type	Includes
<input checked="" type="checkbox"/> Essentials	Base Firewall Capabilities
<input checked="" type="checkbox"/> Carrier (7.3+ FTDs only)	GTP/GPRS, Diameter, SCTP, M3UA
<input checked="" type="checkbox"/> IPS	Intrusion Policy
<input checked="" type="checkbox"/> Malware Defense	File Policy
<input checked="" type="checkbox"/> URL	URL Reputation
<input type="checkbox"/> RA VPN <input type="text" value="VPNOnly"/>	RA VPN

**Next**

**Enable subscription licenses.** CDO will attempt to enable the selected licenses when the device is connected to CDO and registered with the supplied Smart License. Learn more about [Cisco Smart Accounts](#).

**Step 10** (Optional) Add labels to your device to help sort and filter the **Inventory** page. Enter a label and select the blue plus button (+). Labels are applied to the device after it's onboarded to CDO.

**Figure 15: Done**

### What to do next

From the **Inventory** page, select the device you just onboarded and select any of the option listed under the **Management** pane located to the right.

## Onboard the Firewall with Manual Provisioning

Onboard the firewall using a CLI registration key.

- Step 1** In the CDO navigation pane, click **Inventory**, then click the blue plus button (+) to **Onboard** a device.
- Step 2** Click the **FTD** tile.
- Step 3** Under **Management Mode**, be sure **FTD** is selected.
- Step 4** Select **Use CLI Registration Key** as the onboarding method.

**Figure 16: Use CLI Registration Key**

**Step 5** Enter the **Device Name** and click **Next**.

**Figure 17: Device Name**

**Step 6** For the **Policy Assignment**, use the drop-down menu to choose an access control policy for the device. If you have no policies configured, choose the **Default Access Control Policy**.

**Figure 18: Access Control Policy**

2 Policy Assignment

Access Control Policy

Default Access Control Policy ▾

Next

**Step 7** For the **Subscription License**, click the **Physical FTD Device** radio button, and then check each of the feature licenses you want to enable. Click **Next**.

**Figure 19: Subscription License**

3 Subscription License

Please indicate if this FTD is physical or virtual:

Physical FTD Device

Virtual FTD Device

License Type	Includes
<input checked="" type="checkbox"/> Essentials	Base Firewall Capabilities
<input checked="" type="checkbox"/> Carrier (7.3+ FTDs only)	GTP/GPRS, Diameter, SCTP, M3UA
<input checked="" type="checkbox"/> IPS	Intrusion Policy
<input checked="" type="checkbox"/> Malware Defense	File Policy
<input checked="" type="checkbox"/> URL	URL Reputation
<input checked="" type="checkbox"/> RA VPN <span>Premier ▾</span>	RA VPN

Next

**Step 8** For the **CLI Registration Key**, CDO generates a command with the registration key and other parameters. You must copy this command and use it in the initial configuration of the threat defense.

**Figure 20: CLI Registration Key**

4 CLI Registration Key

1 Ensure the device's initial configuration is complete before trying to apply the registration key. [Learn more](#)

2 Copy the CLI Key below and paste it into the CLI of the FTD

```
configure manager add cisco-security-docs.app.us.cdo.cisco.com
BanyI2oaT0ew1JTpC0P2w3xEBnVvkfZv x7R7dwcM43JCMzWGY3ZzCfoFmZhW97my cisco-security-
docs.app.us.cdo.cisco.com
```

Next

**configure manager add cdo\_hostname registration\_key nat\_id display\_name**

Complete initial configuration at the CLI or using the device manager:





- Ethernet 1/1—**outside**, IP address from DHCP, IPv6 autoconfiguration
- Ethernet 1/2— **inside**, 192.168.95.1/24
- Default route—Obtained through DHCP on the outside interface
- Additional interfaces—Any interface configuration from the device manager is preserved.

Other settings, such as the DHCP server on inside, access control policy, or security zones, are not preserved.

**Step 1** Connect your computer to the inside interface (Ethernet 1/2).

**Step 2** Log into the device manager.

- Go to <https://192.168.95.1>.
- Log in with the username **admin** and the default password **Admin123**.
- You are prompted to read and accept the General Terms and change the admin password.

**Step 3** Use the setup wizard.

**Figure 23: Device Setup**

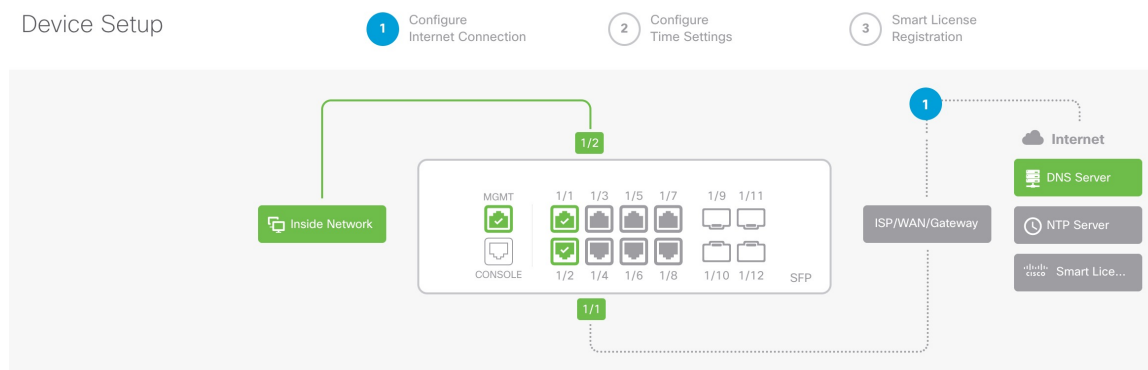

**Note** The exact port configuration depends on your model.

- Configure the outside and management interfaces.

Figure 24: Connect firewall to internet

## Connect firewall to Internet

The initial access control policy will enforce the following actions.  
You can edit the policy after setup.

<p>Rule 1 <b>Trust Outbound Traffic</b></p> <p>This rule allows traffic to go from inside to outside, which is needed for the Smart License configuration.</p>	<p>Default Action <b>Block all other traffic</b></p> <p>The default action blocks all other traffic.</p>
--	--

---

### Outside Interface Address

Connect Ethernet1/1 (Outside) to your ISP/WAN device, for example, your cable modem or router. Then, configure the addresses for the outside interface.

**Configure IPv4**

Using DHCP ▼

**Configure IPv6**

Using DHCP ▼

---

NEXT
Don't have internet connection?  
[Skip device setup](#) ⓘ

1. **Outside Interface Address**—Use a static IP address if you plan for high availability. You cannot configure PPPoE using the setup wizard; you can configure PPPoE after you complete the wizard.
2. **Management Interface**—The Management interface settings are used even though you are using manager access on the outside interface. For example, management traffic that is routed over the backplane through the outside interface will resolve FQDNs using these Management interface DNS servers, and not the outside interface DNS servers.

**DNS Servers**—The DNS server for the system's management address. The default is the OpenDNS public DNS servers. These will probably match the outside interface DNS servers you set later since they are both accessed from the outside interface.

#### **Firewall Hostname**

- b) Configure the **Time Setting (NTP)** and click **Next**.

Figure 25: Time Setting (NTP)

### Time Setting (NTP)

System Time: 11:56:20AM October 03 2024 -06:00

Time Zone for Scheduling Tasks

(UTC+00:00) UTC

NTP Time Server

Default NTP Servers

Server Name

0.sourcefire.pool.ntp.org

1.sourcefire.pool.ntp.org

2.sourcefire.pool.ntp.org

[NEXT](#)

- c) Select **Start 90 day evaluation period without registration**.

### Register with Cisco Smart Software Manager

Register with Cisco Smart Software Manager to use the full functionality of this device and to apply subscription licenses.

[What is smart license? ↗](#)

**Continue with evaluation period: Start 90-day evaluation period without registration**  
**Recommended if device will be cloud managed.** [Learn More ↗](#)

Please make sure you register with Cisco before the evaluation period ends.  
Otherwise you will not be able to make any changes to the device configuration.

*Do not* register the threat defense with the Smart Software Manager; all licensing is performed on the CDO.

- d) Click **Finish**.

Figure 26: What's Next

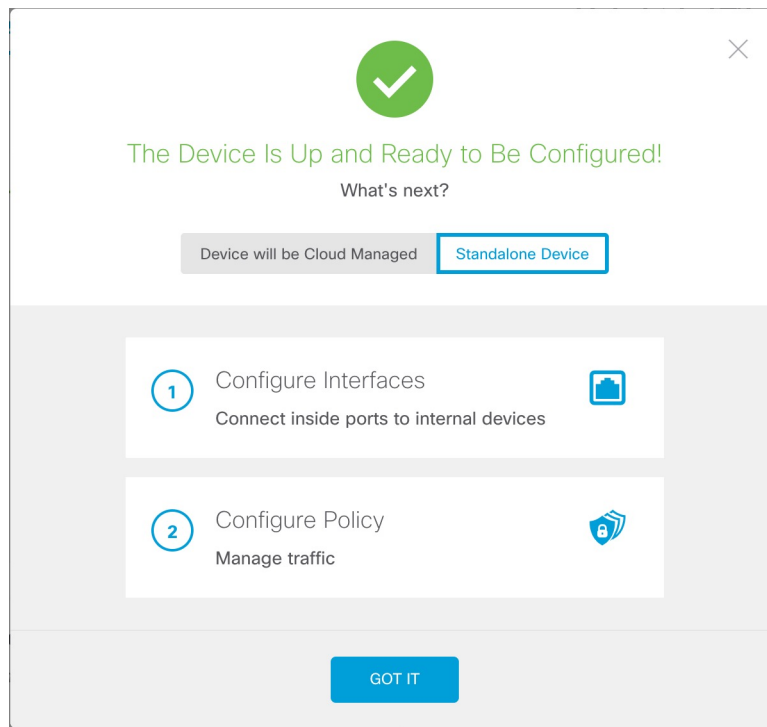

e) Choose **Standalone Device**, and then **Got It**.

**Step 4** If you want to configure additional interfaces, choose **Device**, and then click the link in the **Interfaces** summary.

**Step 5** Register with the CDO by choosing **Device > System Settings > Central Management** and clicking **Proceed**

Configure the **Management Center/CDO Details**.

Figure 27: Management Center/CDO Details

### Configure Connection to Management Center or CDO

Provide details to register to the management center/CDO.

Management Center/CDO Details

Do you know the Management Center/CDO hostname or IP address?

Yes  No

**Threat Defense**



10.89.5.16  
fe80::6a87:c6ff:fea6:4c00/64

→

**Management Center/CDO**



10.89.5.35

Management Center/CDO Hostname or IP Address

10.89.5.35

Management Center/CDO Registration Key

••••

NAT ID

*Required when the management center/CDO hostname or IP address is not provided. We recommend always setting the NAT ID even when you specify the management center/CDO hostname or IP address.*

11203

---

### Connectivity Configuration

Threat Defense Hostname

1120-3

DNS Server Group

CustomDNSServerGroup

Management Center/CDO Access Interface

Data Interface

Please select an interface

Management Interface [View details](#)

- a) For **Do you know the Management Center/CDO hostname or IP address**, click **Yes**.

CDO generates the **configure manager add** command. See [Onboard the Firewall with Manual Provisioning, on page 13](#) to generate the command.



Figure 29: Successful Connection

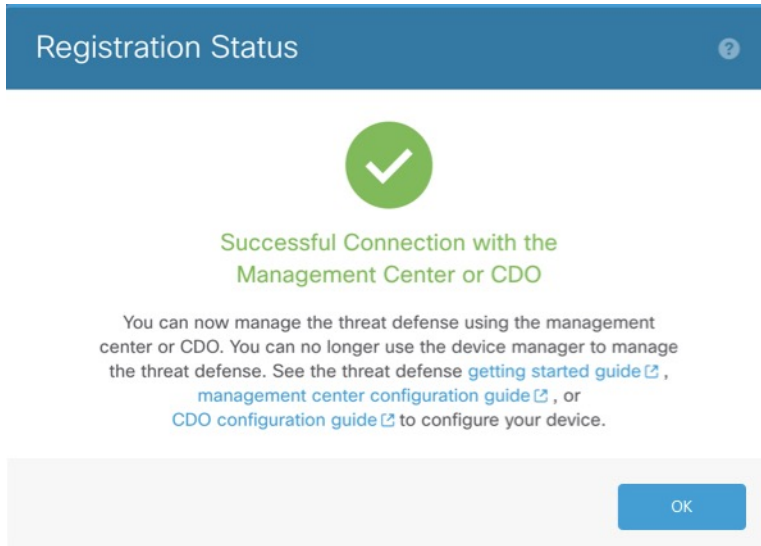

- Step 9** After the **Saving Management Center/CDO Registration Settings** step on the status screen, go to the CDO and add the firewall. See [Onboard the Firewall with Manual Provisioning, on page 13](#).

## Initial Configuration: CLI

Set the dedicated Management IP address, gateway, and other basic networking settings using the CLI setup script.

- Step 1** Connect to the console port and access the threat defense CLI. See [Access the Threat Defense CLI, on page 3](#).

- Step 2** Complete the CLI setup script for the Management interface settings.

**Note** You cannot repeat the CLI setup script unless you clear the configuration, for example, by reimaging. However, all of these settings can be changed later at the CLI using **configure network** commands. See [Cisco Secure Firewall Threat Defense Command Reference](#).

```
You must accept the EULA to continue.
Press <ENTER> to display the EULA:
Cisco General Terms
[...]
```

```
Please enter 'YES' or press <ENTER> to AGREE to the EULA:
```

```
System initialization in progress. Please stand by.
You must configure the network to continue.
Configure at least one of IPv4 or IPv6 unless managing via data interfaces.
Do you want to configure IPv4? (y/n) [y]:
Do you want to configure IPv6? (y/n) [y]: n
```

**Guidance:** Enter **y** for at least one of these types of addresses. Although you do not plan to use the Management interface, you must set an IP address, for example, a private address.



Configure IPv4 via DHCP or manually? (dhcp/manual) [manual]:

**Guidance:** Choose **manual**. DHCP is not supported when using the outside interface for manager access. Make sure this interface is on a different subnet from the manager access interface to prevent routing issues.

Enter an IPv4 address for the management interface [192.168.45.61]: **10.89.5.17**  
 Enter an IPv4 netmask for the management interface [255.255.255.0]: **255.255.255.192**  
 Enter the IPv4 default gateway for the management interface [data-interfaces]:

**Guidance:** Set the gateway to be **data-interfaces**. This setting forwards management traffic over the backplane so it can be routed through the outside interface.

Enter a fully qualified hostname for this system [firepower]: **1010-3**  
 Enter a comma-separated list of DNS servers or 'none' [208.67.222.222,208.67.220.220,2620:119:35::35]:  
 Enter a comma-separated list of search domains or 'none' []: **cisco.com**  
 If your networking information has changed, you will need to reconnect.  
 Disabling IPv6 configuration: management0  
 Setting DNS servers: 208.67.222.222,208.67.220.220,2620:119:35::35  
 Setting DNS domains:cisco.com

**Guidance:** Set the Management interface DNS servers. These will probably match the outside interface DNS servers you set later, since they are both accessed from the outside interface.

Setting hostname as 1010-3  
 Setting static IPv4: 10.89.5.17 netmask: 255.255.255.192 gateway: data on management0  
 Updating routing tables, please wait...  
 All configurations applied to the system. Took 3 Seconds.  
 Saving a copy of running network configuration to local disk.  
 For HTTP Proxy configuration, run 'configure network http-proxy'

Manage the device locally? (yes/no) [yes]: **no**

**Guidance:** Enter **no** to use the management center.

Setting hostname as 1010-3  
 Setting static IPv4: 10.89.5.17 netmask: 255.255.255.192 gateway: data on management0  
 Updating routing tables, please wait...  
 All configurations applied to the system. Took 3 Seconds.  
 Saving a copy of running network configuration to local disk.  
 For HTTP Proxy configuration, run 'configure network http-proxy'

**Guidance:** Enter **routed**. Outside manager access is only supported in routed firewall mode.

Configuring firewall mode ...

Device is in OffBox mode - disabling/removing port 443 from iptables.  
 Update policy deployment information  
 - add device configuration  
 - add network discovery  
 - add system policy

You can register the sensor to a Firepower Management Center and use the Firepower Management Center to manage it. Note that registering the sensor to a Firepower Management Center disables on-sensor Firepower Services management capabilities.

When registering the sensor to a Firepower Management Center, a unique alphanumeric registration key is always required. In most cases, to register a sensor to a Firepower Management Center, you must provide the hostname or the IP address along with the registration key.  
 'configure manager add [hostname | ip address ] [registration key ]'

However, if the sensor and the Firepower Management Center are separated by a NAT device, you must enter a unique NAT ID, along with the unique registration key.

```
'configure manager add DONTRESOLVE [registration key ] [ NAT ID ]'
```

Later, using the web interface on the Firepower Management Center, you must use the same registration key and, if necessary, the same NAT ID when you add this sensor to the Firepower Management Center.

```
>
```

**Step 3** Configure the outside interface for manager access.

#### **configure network management-data-interface**

You are then prompted to configure basic network settings for the outside interface.

#### **Manual IP Address**

```
> configure network management-data-interface
Data interface to use for management: ethernet1/1
Specify a name for the interface [outside]: internet
IP address (manual / dhcp) [dhcp]: manual
IPv4/IPv6 address: 10.10.6.7
Netmask/IPv6 Prefix: 255.255.255.0
Default Gateway: 10.10.6.1
Comma-separated list of DNS servers [none]: 208.67.222.222,208.67.220.220
```

**Guidance:** To retain the outside DNS servers after registration, you need to re-configure the DNS Platform Settings in the management center.

```
DDNS server update URL [none]:
Do you wish to clear all the device configuration before applying ? (y/n) [n]:
```

Configuration done with option to allow manager access from any network, if you wish to change the manager access network use the 'client' option in the command 'configure network management-data-interface'.

```
Setting IPv4 network configuration.
Network settings changed.
```

```
>
```

#### **IP Address from DHCP**

```
> configure network management-data-interface
Data interface to use for management: ethernet1/1
Specify a name for the interface [outside]:
IP address (manual / dhcp) [dhcp]:
DDNS server update URL [none]:
https://dwinchester:pa$$w0rd17@domains.example.com/nic/update?hostname=<h>&myip=<a>
Do you wish to clear all the device configuration before applying ? (y/n) [n]:
```

Configuration done with option to allow manager access from any network, if you wish to change the manager access network use the 'client' option in the command 'configure network management-data-interface'.

```
Setting IPv4 network configuration.
Network settings changed.
```

```
>
```

**Step 4** Identify the CDO that will manage this threat defense using the **configure manager add** command that CDO generated. See [Onboard the Firewall with Manual Provisioning, on page 13](#) to generate the command.

**Example:**

```
> configure manager add account1.app.us.cdo.cisco.com KPOOP0rgWzaHrnj1V5ha2q5Rf8pKFX9E  
Lzm1HOynhVUWhXYWz2swmkj2ZWsN3Lb account1.app.us.cdo.cisco.com  
Manager successfully configured.
```

**Step 5**

Shut down the threat defense so you can send the device to the remote branch office.

It's important that you shut down your system properly. Simply unplugging the power or pressing the power switch can cause serious file system damage. Remember that there are many processes running in the background all the time, and unplugging or shutting off the power does not allow the graceful shutdown of your system.

- a) Enter the **shutdown** command.
  - b) Observe the Power LED and Status LED to verify that the chassis is powered off (appear unlit).
  - c) After the chassis has successfully powered off, you can then unplug the power to physically remove power from the chassis if necessary.
-





## CHAPTER 3

# Configure a Basic Policy

Configure a basic security policy with the following settings:

- Inside and outside interfaces—Assign a static IP address to the inside interface, and use DHCP for the outside interface.
- DHCP server—Use a DHCP server on the inside interface for clients.
- Default route—Add a default route through the outside interface.
- NAT—Use interface PAT on the outside interface.
- Access control—Allow traffic from inside to outside.

You can also customize your security policy to include more advanced inspections.

- [Configure Interfaces, on page 27](#)
- [Configure the DHCP Server, on page 31](#)
- [Configure NAT, on page 32](#)
- [Configure an Access Control Rule, on page 35](#)
- [Enable SSH on the Outside Interface, on page 38](#)
- [Deploy the Configuration, on page 39](#)

## Configure Interfaces

When you use zero-touch provisioning or the device manager for initial setup, the following interfaces are preconfigured:

- Ethernet 1/1—**outside**, IP address from DHCP, IPv6 autoconfiguration
- Ethernet 1/2— **inside**, 192.168.95.1/24
- Default route—Obtained through DHCP on the outside interface

If you performed additional interface-specific configuration within device manager before registering with the management center, then that configuration is preserved.

The following example configures a routed-mode inside interface with a static address and a routed-mode outside interface using DHCP. It also adds a DMZ interface for an internal web server.

- Step 1** Choose **Devices > Device Management**, and click **Edit** (✎) for the firewall.
- Step 2** Click **Interfaces**.

**Figure 30: Interfaces**

Interface	Logical Name	Type	Security Zones	MAC Address (Active/Standby)	IP Address	Path Monitoring	Virtual Router	
Management0/0	management	Physical				Disabled	Global	🔍 <
<input checked="" type="checkbox"/> GigabitEthernet0/0		Physical				Disabled		✎
<input checked="" type="checkbox"/> GigabitEthernet0/1		Physical				Disabled		✎
<input checked="" type="checkbox"/> GigabitEthernet0/2		Physical				Disabled		✎
<input checked="" type="checkbox"/> GigabitEthernet0/3		Physical				Disabled		✎
<input checked="" type="checkbox"/> GigabitEthernet0/4		Physical				Disabled		✎
<input checked="" type="checkbox"/> GigabitEthernet0/5		Physical				Disabled		✎
<input checked="" type="checkbox"/> GigabitEthernet0/6		Physical				Disabled		✎
<input checked="" type="checkbox"/> GigabitEthernet0/7		Physical				Disabled		✎

- Step 3** Click **Edit** (✎) for the interface that you want to use for inside.

**Figure 31: General Tab**

### Edit Physical Interface

General | IPv4 | IPv6 | Path Monitoring | Help

Name:

Enabled  
 Management Only

Description:

Mode:

Security Zone:

Interface ID:

MTU:  
  
(64 - 9000)

Priority:  
 (0 - 65535)

Propagate Security Group Tag:

NVE Only:

- a) From the **Security Zone** drop-down list, choose an existing inside security zone or add a new one by clicking **New**.  
For example, add a zone called **inside\_zone**. You apply your security policy based on zones or groups. For example, configure your access control policy to enable traffic to go from the inside zone to the outside zone, but not from outside to inside.

If the inside interface was preconfigured, the rest of these fields are optional.

- b) Enter a **Name** up to 48 characters in length.

For example, name the interface **inside**.

- c) Check the **Enabled** check box.

- d) Leave the **Mode** set to **None**.

- e) Click the **IPv4** and/or **IPv6** tab.

- **IPv4**—Choose **Use Static IP** from the drop-down list, and enter an IP address and subnet mask in slash notation.

For example, enter **192.168.1.1/24**

**Figure 32: IPv4 Tab**

Edit Physical Interface

General IPv4 IPv6 Path Monitoring

IP Type:  
Use Static IP

IP Address:  
192.168.1.1/24  
eg. 192.0.2.1/255.255.255.128 or 192.0.2.1/25

- **IPv6**—Check the **Autoconfiguration** check box for stateless autoconfiguration.

**Figure 33: IPv6 Tab**

Edit Physical Interface

General IPv4 IPv6 Path Monitoring Hardware Configu

Basic Address Prefixes Settings DHCP

Enable IPV6:

Enforce EUI 64:

Link-Local address:

Autoconfiguration:

Obtain Default Route:

- f) Click **OK**.

**Step 4** Click **Edit** (✎) for the interface that you want to use for outside.

Figure 34: General Tab

Edit Physical Interface

General IPv4 IPv6 Path Monitoring Hardware

Name:

Enabled  
 Management Only

Description:

Mode:

Security Zone:

Interface ID:

MTU:  
  
(64 - 9000)

Priority:  
 (0 - 65535)

Propagate Security Group Tag:

NVE Only:

- a) From the **Security Zone** drop-down list, choose an existing outside security zone or add a new one by clicking **New**.

For example, add a zone called **outside\_zone**.

You should not alter any other basic settings because doing so will disrupt the management center management connection.

- b) Click **OK**.

**Step 5** Configure a DMZ interface to host a web server, for example.

- a) Click **Edit** (✎) for the interface you want to use.  
 b) From the **Security Zone** drop-down list, choose an existing DMZ security zone or add a new one by clicking **New**.

For example, add a zone called **dmz\_zone**.

- c) Enter a **Name** up to 48 characters in length.

For example, name the interface **dmz**.

- d) Check the **Enabled** check box.  
 e) Leave the **Mode** set to **None**.  
 f) Click the **IPv4** and/or **IPv6** tab and configure the IP address as desired.  
 g) Click **OK**.



**Step 6** Click **Save**.

## Configure the DHCP Server

Enable the DHCP server if you want clients to use DHCP to obtain IP addresses from the firewall.

**Step 1** Choose **Devices > Device Management**, and click **Edit** (✎) for the device.

**Step 2** Choose **DHCP > DHCP Server**.

*Figure 35: DHCP Server*

The screenshot displays the DHCP Server configuration interface. At the top, there are tabs for Device, Routing, Interfaces, Inline Sets, **DHCP**, VTEP, and SNMP. On the left, a sidebar lists DHCP Server, DHCP Relay, and DDNS. The main configuration area includes:

- Ping Timeout:** A text input field containing '50' with a range of '(10 - 10000 ms)'.
- Lease Length:** A text input field containing '3600' with a range of '(300 - 10,48,575 sec)'.
- Auto-Configuration:** An unchecked checkbox.
- Interface:** A dropdown menu.
- Override Auto Configured Settings:**
  - Domain Name:** A text input field.
  - Primary DNS Server:** A dropdown menu.
  - Secondary DNS Server:** A dropdown menu.
  - Primary WINS Server:** A dropdown menu.
  - Secondary WINS Server:** A dropdown menu.

At the bottom, there is a 'Server' tab (highlighted with a red box) and an 'Advanced' section. A '+ Add' button (also highlighted with a red box) is located in the bottom right corner of the configuration area. Below the configuration fields is a table with columns for 'Interface', 'Address Pool', and 'Enable DHCP Server'. The table is currently empty, with the text 'No records to display' below it.

**Step 3** In the **Server** area, click **Add** and configure the following options.

Figure 36: Add Server

**Add Server** ⓘ

Interface\*  
inside

Address Pool\*  
192.168.1.2-192.168.1.55  
(2.2.2.10-2.2.2.20)

Enable DHCP Server

Cancel OK

- **Interface**—Choose the interface name from the drop-down list.
- **Address Pool**—Set the range of IP addresses. The IP addresses must be on the same subnet as the selected interface and cannot include the IP address of the interface itself.
- **Enable DHCP Server**—Enable the DHCP server on the selected interface.

**Step 4** Click **OK**.

**Step 5** Click **Save**.

---

## Configure NAT

This procedure creates a NAT rule for internal clients to convert the internal addresses to a port on the outside interface IP address. This type of NAT rule is called *interface Port Address Translation (PAT)*.

---

**Step 1** Choose **Devices > NAT**, and click **New Policy**.

**Step 2** Name the policy, select the devices that you want to use the policy, and click **Save**.

Figure 37: New Policy

**New Policy**

**Name:**  
FTD\_policy

**Description:**  
[Empty text box]

**Targeted Devices**  
Select devices to which you want to apply this policy.

**Available Devices and Templates**  
Search by name or value  
192.168.0.124  
192.168.0.155

**Selected Devices and Templates**  
192.168.0.124  
192.168.0.155

Add to Policy

Cancel Save

The policy is added the management center. You still have to add rules to the policy.

Figure 38: NAT Policy

**FTD\_Policy** Show Warnings Save Cancel

Enter Description

Rules NAT Exemptions Policy Assignments (1)

Filter by Device Filter Rules Add Rule

	#	Direction	Type	Source Interface Objects	Destination Interface Objects	Original Packet			Translated Packet			Options
						Original Sources	Original Destinations	Original Services	Translated Sources	Translated Destinations	Translated Services	
NAT Rules Before												
Auto NAT Rules												
NAT Rules After												

**Step 3** Click **Add Rule**.

**Step 4** Configure the basic rule options:

Figure 39: Basic Rule Options

- **NAT Rule**—Choose **Auto NAT Rule**.
- **Type**—Choose **Dynamic**.

**Step 5** On the **Interface Objects** page, add the outside zone from the **Available Interface Objects** area to the **Destination Interface Objects** area.

Figure 40: Interface Objects

**Step 6** On the **Translation** page, configure the following options:

Figure 41: Translation

- **Original Source**—Click **Add (+)** to add a network object for all IPv4 traffic (**0.0.0.0/0**).

Figure 42: New Network Object

**New Network Object** ⓘ

**Name**  
all-ipv4

**Description**

**Network**  
 Host     Range     Network     FQDN

0.0.0.0/0

Allow Overrides

Cancel Save

**Note** You cannot use the system-defined **any-ipv4** object, because Auto NAT rules add NAT as part of the object definition, and you cannot edit system-defined objects.

- **Translated Source**—Choose **Destination Interface IP**.

**Step 7** Click **Save** to add the rule.

The rule is saved to the **Rules** table.

**Step 8** Click **Save** on the **NAT** page to save your changes.

## Configure an Access Control Rule

If you created a basic **Block all traffic** access control policy when you registered the device, then you need to add rules to the policy to allow traffic through the device. The access control policy can include multiple rules that are evaluated in order.

This procedure creates an access control rule to allow all traffic from the inside zone to the outside zone.

**Step 1** Choose **Policy > Access Policy > Access Policy**, and click **Edit** (✎) for the access control policy assigned to the device.

**Step 2** Click **Add Rule**, and set the following parameters.

Figure 43: Source Zone

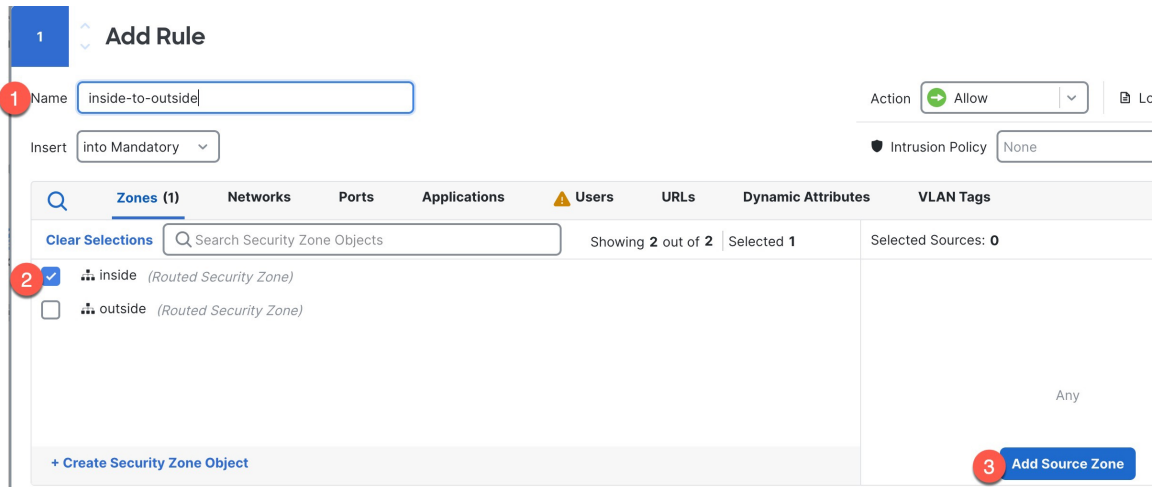

1. Name this rule, for example, **inside-to-outside**.
2. Select the inside zone from **Zones**
3. Click **Add Source Zone**.

Figure 44: Destination Zone

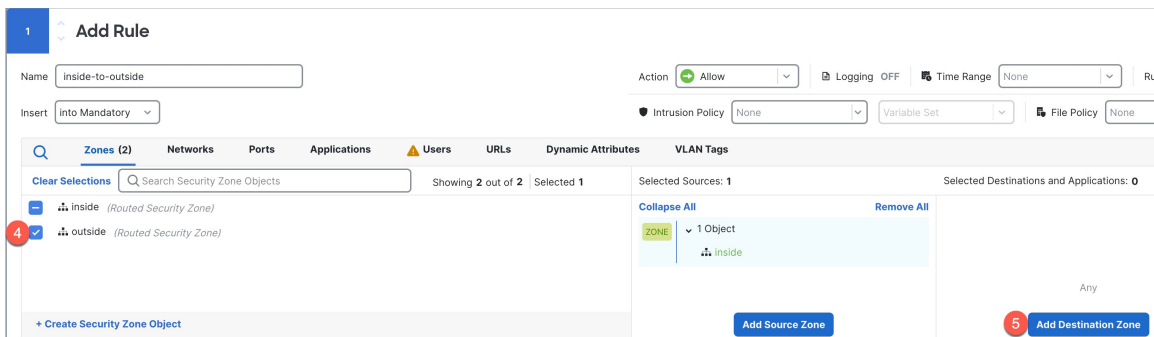

4. Select the outside zone from **Zones**.
5. Click **Add Destination Zone**.

Leave the other settings as is.

**Step 3** (Optional) Customize associated policies by clicking on the policy type in the packet flow diagram.

Prefilter, Decryption, Security Intelligence, and Identity policies are applied before an access control rule. Customizing these policies is not required, but after you know your network's needs, they let you improve network performance by either fastpathing trusted traffic (bypassing processing) or blocking traffic so no further processing is required.

Figure 45: Policies Applied Before Access Control



- **Prefilter Rules**—The Default Prefilter Policy passes all traffic for the other rules to act on (analyzes). The only change to the default policy you can make is to **block** tunnel traffic. Otherwise, you can create a new prefilter policy to associate with the access control policy that can analyze (pass on), fastpath (bypass further checks) or block.

Prefiltering lets you improve performance by dealing with traffic before it gets any further, by either blocking or fastpathing. In a new policy, you can add *tunnel* rules and *prefilter* rules. A tunnel rule lets you fastpath, block, or rezone plaintext (non-encrypted), passthrough tunnels. A prefilter rule lets you fastpath or block non-tunneled traffic identified by IP address, port, and protocol.

For example, if you know you want to block all FTP traffic on your network, but fastpath SSH traffic from an administrator, you can add a new prefilter policy.

- **Decryption**—Decryption is not applied by default. Decryption is a way to expose network traffic to deep inspection. In most cases, you don't want to decrypt traffic, and can only do so if it is legally allowed. For maximum network protection, a decryption policy might be a good idea for traffic going to critical servers or coming from untrusted network segments.
- **Security Intelligence**—(Requires the IPS license) Security Intelligence is enabled by default. Security Intelligence is another early defense against malicious activity applied before passing connections to the access control policy for further processing. Security Intelligence uses reputation intelligence to quickly block connections to or from IP addresses, URLs, and domain names provided by Talos, the threat intelligence organization at Cisco. You can add or delete additional IP addresses, URLs, or domains if desired.

**Note** If you do not have the IPS license, this policy will not be deployed even though it shows in your access control policy as enabled.

- **Identity**—Identity is not applied by default. You can require a user to authenticate before allowing traffic to be processed by the access control policy.

**Step 4** (Optional) Add an Intrusion policy that is applied after the access control rule.

The Intrusion policy is a defined set of intrusion detection and prevention configurations that inspects traffic for security violations. The management center includes many system-provided policies you can enable as-is or that you can customize. This step enables a system-provided policy.

- Click the **Intrusion Policy** drop-down list.

**Figure 46: System-Provided Intrusion Policies**

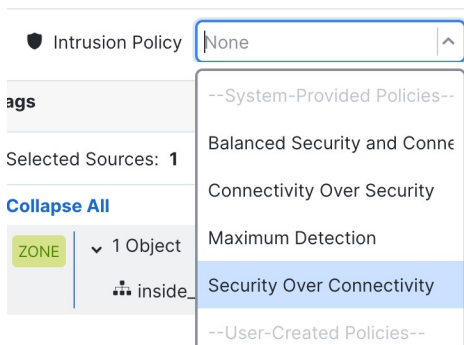

- Choose one of the system-provided policies from the list.

**Step 5** (Optional) Add a File policy that is applied after the access control rule.

- a) Click the **File Policy** drop-down list and choose either an existing policy or add one by choosing the **Open File Policy List**.

*Figure 47: File Policy*

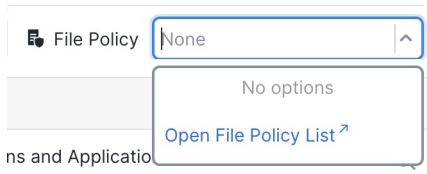

For a new policy, the **Policies > Malware & File** page opens in a separate tab.

- b) See the [Cisco Secure Firewall Device Manager Configuration Guide](#) for details on creating the policy.  
 c) Return to the **Add Rule** page and select the newly created policy from the drop-down list.

**Step 6** Click **Apply**.

The rule is added to the **Rules** table.

**Step 7** Click **Save**.

## Enable SSH on the Outside Interface

This section describes how to enable SSH connections to the outside interface.

By default, you can use the **admin** user for which you configured the password during initial setup.

**Step 1** Choose **Devices > Platform Settings** and create or edit the threat defense policy.

**Step 2** Select **SSH Access**.

**Step 3** Identify the outside interface and IP addresses that allow SSH connections.

- a) Click **Add** to add a new rule, or click **Edit** to edit an existing rule.  
 b) Configure the rule properties:
- **IP Address**—The network object or group that identifies the hosts or networks you are allowing to make SSH connections. Choose an object from the drop-down menu, or click + to add a new network object.
  - **Available Zones/Interfaces**—Add the outside zone or type the **outside** interface name into the field below the **Selected Zones/Interfaces** list and click **Add**.



Figure 48: Enable SSH on the Outside Interface

**Edit Secure Shell Configuration**

IP Address\*  
any-ipv4 +

Available Zones/Interfaces  **Add**

DMZ  
inside  
outside

Selected Zones/Interfaces

outside **Add**

**Cancel** **OK**

c) Click **OK**.

**Step 4** Click **Save**.

You can now go to **Deploy > Deployment** and deploy the policy to assigned devices. The changes are not active until you deploy them.

## Deploy the Configuration

Deploy the configuration changes to the device; none of your changes are active on the device until you deploy them.

**Step 1** Click **Deploy** in the upper right.

Figure 49: Deploy

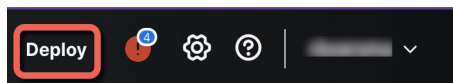

**Step 2** For a quick deployment, check specific devices and then click **Deploy**.

Figure 50: Deploy Selected

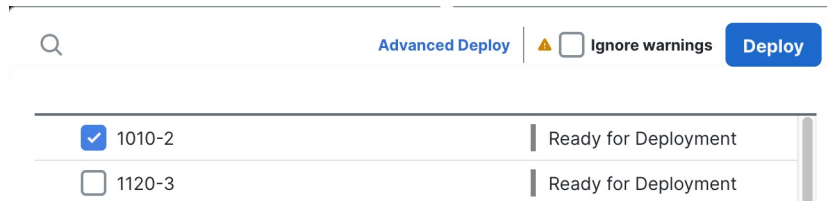

Or click **Deploy All** to deploy to all devices.

Figure 51: Deploy All

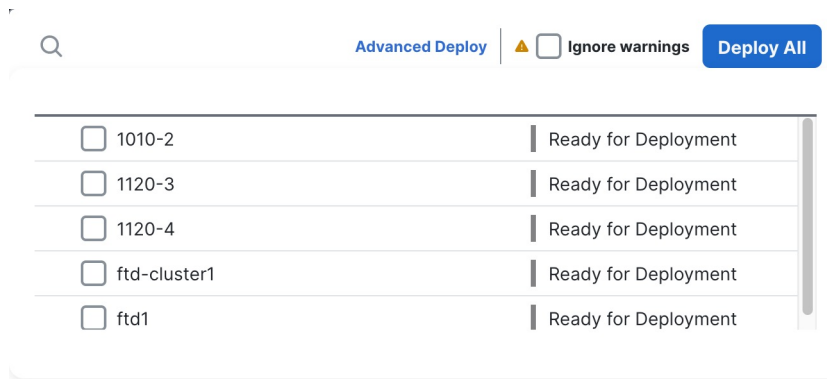

5 devices are available for deployment

Otherwise, for additional deployment options, click **Advanced Deploy**.

Figure 52: Advanced Deployment

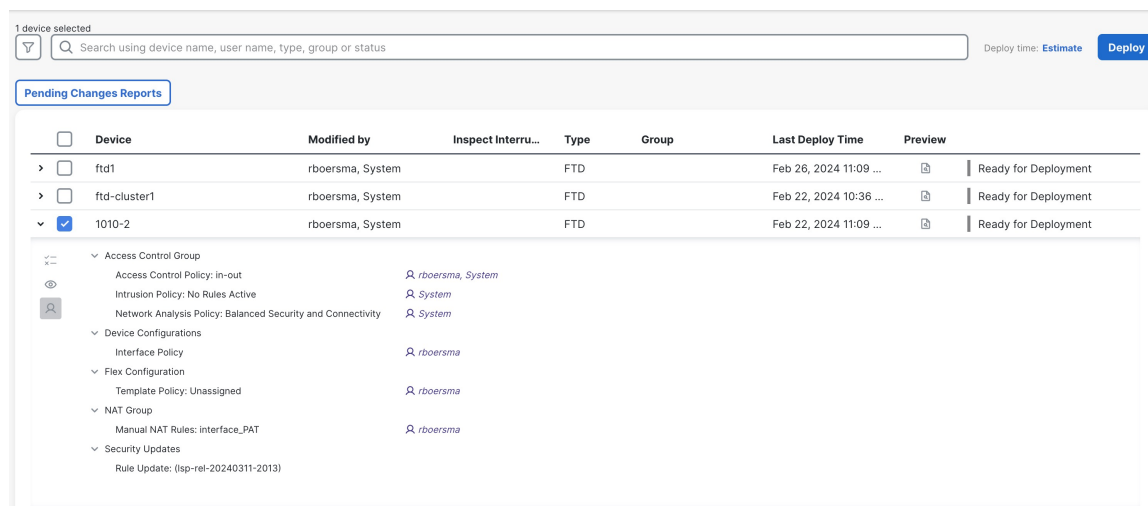

**Step 3** Ensure that the deployment succeeds. Click the icon to the right of the **Deploy** button in the menu bar to see status for deployments.

Figure 53: Deployment Status

